



INSTRUCTIONS FOR: AIR TYRE BUFFER PREMIER MODEL No: **SA651.V3**

Thank you for purchasing a Sealey Product. Manufactured to a high standard this product will, if used according to these instructions and properly maintained, give you years of trouble free performance.



IMPORTANT: PLEASE READ THESE INSTRUCTIONS CAREFULLY. NOTE THE SAFE OPERATIONAL REQUIREMENTS, WARNINGS AND CAUTIONS. USE THIS PRODUCT CORRECTLY AND WITH CARE FOR THE PURPOSE FOR WHICH IT IS INTENDED. FAILURE TO DO SO MAY CAUSE DAMAGE OR PERSONAL INJURY AND WILL INVALIDATE THE WARRANTY. PLEASE KEEP INSTRUCTIONS SAFE FOR FUTURE USE.

1. SAFETY INSTRUCTIONS

- ✓ Follow all workshop safety rules, regulations, and conditions when using the tyre buffer.
- ☐ **WARNING!** Disconnect from air supply before changing accessories or servicing.
- ✓ Maintain the tyre buffer in good condition and replace any damaged or worn parts.
Use genuine parts only. Unauthorised parts may be dangerous and will invalidate the warranty.
- ☐ **WARNING!** Check correct air pressure is maintained and not exceeded. We recommend 90psi.
- ✓ Keep air hose away from heat, oil and sharp edges. Check air hose for wear before each use and ensure that all connections are secure.
- ✓ Wear approved safety eye/face shield, ear defenders, and hand protection.
- ✓ Only use tyre buffer cones which are specifically designed for use with this tyre buffer.
- ✓ Ensure tyre is adequately secured before using the tyre buffer.
- ✓ Maintain correct balance and footing. Ensure the floor is not slippery and wear non-slip shoes.
- ✓ Keep children and non essential persons away from the working area.
- x **DO NOT** use the tyre buffer for a task it is not designed to perform.
- ☐ **WARNING! DO NOT** use the tyre buffer if it is damaged, or if its thought to be faulty. (Contact Service Agent).
- x **DO NOT** use the tyre buffer unless you have been instructed in its use by a qualified person.
- x **DO NOT** carry the tyre buffer by the air hose, or yank the hose from the air supply.
- x **DO NOT** operate the tyre buffer if you are tired or under the influence of alcohol, drugs or intoxicating medication.
- x **DO NOT** carry the tyre buffer with your hand on the power trigger, in order to avoid unintentional starting.
- x **DO NOT** direct air from the air hose at yourself, others or animals.
- ✓ When not in use, disconnect from the air supply, clean and store in a safe, dry, childproof location.

2. INTRODUCTION & SPECIFICATION

Composite cover moulded around lightweight aluminium alloy housing reduces effects of chill on operator's hands and provides added control. Air motor with quality bearings for smooth and powerful operation. Exhaust outlet adjusts 360° keeping air flow away from operator. Ideal for buffing / roughing area of tyre to be repaired. Suitable for professional workshop.

Specifications:

Free speed:2500rpm
Air consumption:..... 4cfm
Operating air pressure:..... .90psi

Air inlet size:.....1/4" BSP
Sound power:......87dB.A
Weight: 1.1kg

3. PREPARATION

3.1. Air Supply

- 3.1.1. Clean the air inlet filter weekly. Recommended hook-up is shown in fig.1.
- 3.1.2. Ensure the tyre buffer air valve (trigger) is in the "off" position before connecting to the air supply.
- 3.1.3. An air pressure of 90psi is required and an air flow according to specification.
- 3.1.4. **⚠ WARNING!** Ensure that the air supply is clean and does not exceed 90psi whilst operating the tyre buffer. Too high an air pressure and unclean air will shorten the product's life due to excessive wear, and may be dangerous causing damage and/or personal injury.
- 3.1.5. Drain the air tank daily. Water in the air line will damage the tyre buffer.
- 3.1.6. Line pressure should be increased to compensate for unusually long air hoses (over 8 metres). The minimum hose diameter should be $\frac{1}{4}$ " I.D. and fittings must have the same inside dimensions.
- 3.1.7. Keep hose away from heat, oil and sharp edges. Check hose for wear, and make certain that all connections are secure.

3.2. Couplings.

Vibration may cause failure if a quick change coupling is connected directly to the tyre buffer. To overcome this, connect a leader hose to the buffer. A quick change coupling may then be used to connect the leader hose to the air line recoil hose (see figs.1 & 2).

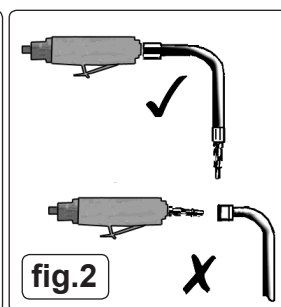
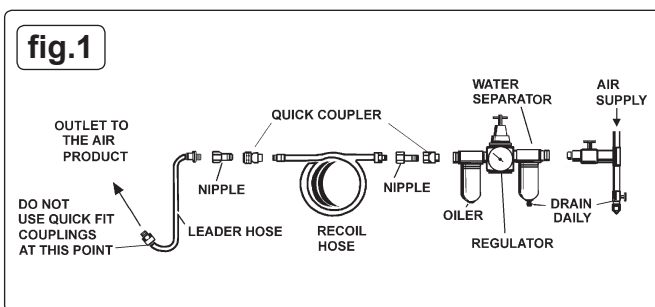

4. OPERATION

- ⚠ WARNING!** Ensure that the safety instructions are read, understood and applied before use.
- 4.1. Only use tyre buffing cones that are specifically designed for use with this tyre buffer. Tyre buffing cone: Part No. SA651/C is available from your Sealey Dealer.
- 4.2. To fit the adaptor, push forward the locking collet on the chuck and push the adaptor into the chuck. Release the locking collet, and check to make sure that the adaptor is locked in position.
- 4.3. Thread the buffing tool bit onto the adaptor and use two spanners to lock it in place.
- 4.4. Connect the tyre buffer to the air hose as in chapter 3.
- 4.5. To start, hold the tyre buffer firmly and push the trigger locking lever forward whilst depressing the trigger. The tyre buffer must be running at its maximum speed and then slowly and smoothly bring the tyre buffer towards the workpiece. Exert adequate pressure on the tyre buffer as required. Avoid subjecting the tyre buffer to excessive strain or harsh impacts. Hold tyre buffer firmly and maintain a controlled adequate progression. **DO NOT** use any additional force upon the tyre buffer.
- 4.6. The flow of air may be regulated by turning the screw on the underside of the tyre buffer. Adjust the exhaust outlet as required, to direct the air flow away from the operator's hands. **DO NOT** allow the tyre buffer to free run for an extended period of time as this will shorten its life.

5. MAINTENANCE

- ❑ **WARNING!** Disconnect the tyre buffer from the air supply before changing accessories, servicing or performing maintenance. Replace or repair any damaged parts. *Use genuine parts only. Unauthorised parts may be dangerous and will invalidate the warranty.*
- 5.1. If the air system does not have an oiler, lubricate the tyre buffer daily, with a few drops of Sealey air tool oil dripped into the air inlet to prolong its life.
- 5.2. Clean the tyre buffer after use. **DO NOT** use worn or damaged buffing cones.
- 5.3. Loss of power or erratic action may be due to the following:
 - a) Excessive drain on the air line. Moisture or restriction in the air pipe. Incorrect size or type of hose connectors. To remedy check the air supply and follow instructions in chapter 3.
 - b) Grit or gum deposits in the tyre buffer may also reduce performance. If the model has an air strainer (located in the area of the air inlet), remove the strainer and clean it. Flush the tyre buffer out with gum solvent oil or an equal mixture of SAE No 10 oil and paraffin. Allow to dry before use.
- 5.4. For a full service, contact your local Sealey service agent.
- 5.5. When not in use, disconnect from air supply, clean tyre buffer and store in a safe, dry, childproof location.



Risk of Hand Arm Vibration Injury.

The SA651.V3 Air Tyre Buffer Premier, when operated in accordance with these instructions and tested in accordance with EN 28662-1: 1993 results in the following vibration emission declared in accordance with BS EN12096: 1996.

Measured vibration emission value: 1.9m/s²

Uncertainty value: 0.76m/s²

These values are suitable for comparison with emission levels of other tools that have been subject to the same test.

This tool may cause hand-arm vibration syndrome if its use is inadequately managed.

Recommended Measures to reduce risk of hand-arm vibration syndrome: This item represents a low Hand Arm Vibration risk to users. The calculated maximum usage period exceeds 8 hours. We recommend appropriate safety equipment is utilised and regular breaks for the operator are employed to reduce any residual risk of fatigue or repetitive strain injury.