



INSTRUCTIONS FOR MOTORCYCLE ENGINE STAND - SINGLE/TWIN CYLINDER

MODEL NO: **MES01**

Thank you for purchasing a Sealey product. Manufactured to a high standard, this product will, if used according to these instructions, and properly maintained, give you years of trouble free performance.

IMPORTANT: PLEASE READ THESE INSTRUCTIONS CAREFULLY. NOTE THE SAFE OPERATIONAL REQUIREMENTS, WARNINGS & CAUTIONS. USE THE PRODUCT CORRECTLY AND WITH CARE FOR THE PURPOSE FOR WHICH IT IS INTENDED. FAILURE TO DO SO MAY CAUSE DAMAGE AND/OR PERSONAL INJURY AND WILL INVALIDATE THE WARRANTY. KEEP THESE INSTRUCTIONS SAFE FOR FUTURE USE.



Refer to
Instruction
Manual

1. SAFETY

- ☐ **WARNING!** *Ensure all Health and Safety, local authority, and general workshop practice regulations are strictly adhered to when using this equipment.*
- ☒ **DO NOT** use unit if damaged.
- ☒ Replace or repair damaged parts. *Use recommended parts only. Unauthorised parts may be dangerous and will invalidate the warranty.*
- ☒ Keep the stand clean for best and safest performance.
- ☒ Locate the stand in a suitable work area. Keep area clean and tidy and free from unrelated materials. Ensure there is adequate lighting.
- ☒ Use on a firm, level surface capable of sustaining the stand and the load.
- ☒ Maintain correct balance and footing. Ensure the floor is not slippery and wear non-slip shoes.
- ☒ Ensure all non-essential persons keep a safe distance whilst the stand is in use.
- ☒ Lock ratchet in position with locking pin before fixing a load and ensure the engine is centred and securely mounted.
- ☒ Ensure the stand and load are stable.
- ☒ **DO NOT** allow untrained persons to use the stand.
- ☒ **DO NOT** exceed the rated capacity of 30kg.
- ☒ **DO NOT** use the stand for purposes other than those for which it is designed.
- ☒ When not in use store stand in a safe, dry, childproof area.

2. INTRODUCTION

Suitable for a wide variety of engines and transmissions. Model no. MES01 is suitable for lower capacity single and twin cylinder engines (maximum weight 30kg) and includes a utility/drip tray.

3. SPECIFICATION

Model no: **MES01**
Maximum capacity: 30kg
Height: 375mm
Width: 320mm
Length: 535mm
Engine support span: 200-375mm

4. ASSEMBLY

- 4.1. Insert post (24) into fixed frame (20), use bolt (22), washer (11) and nut (23) to secure each end.
- 4.2. Fit movable frame (2) to fixed frame (20).
Fit ratchet set (17) to fixed frame (20). Use nut (19) and nut (18) inside frame.
Use bolt (16) and sleeve (15) between fixed frame (20) and moveable frame (2), washer (14) and nut (13) at the ratchet set end.
At the other end use bolt (21), sleeve (15) between the two frames, washer (14) and nut (13).
- 4.3. Fit engine cradle (4) to moveable frame (2) using screw (9) washer (11) and nut (10).
Fit screw (5) into the other end of the engine cradle (4).
Use two nylock nuts (3) either side of the engine cradle.
Screw support tube (7) onto this. Use rod (8) through the end, to tighten.
Fit screw (6) through the moveable frame in the same way as screw (5) was fixed. Screw on support tube (7).
- 4.4. Slide in oil plate (25).
- 4.5. Check all fasteners are secure.

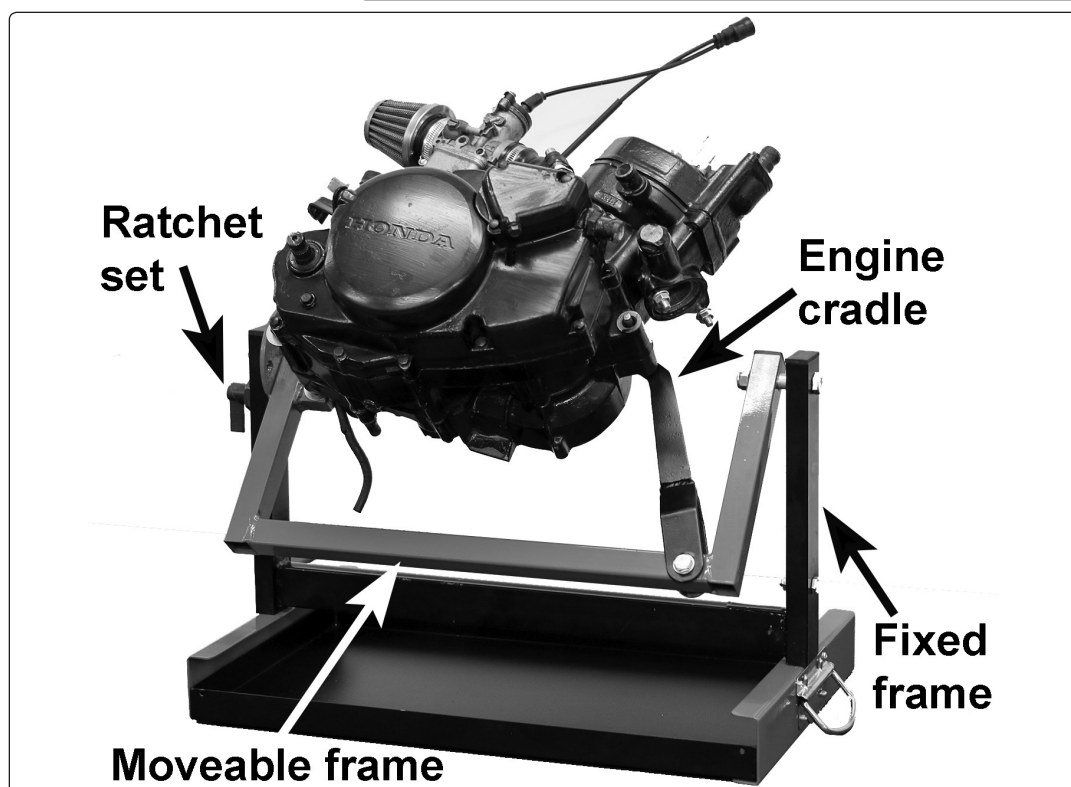
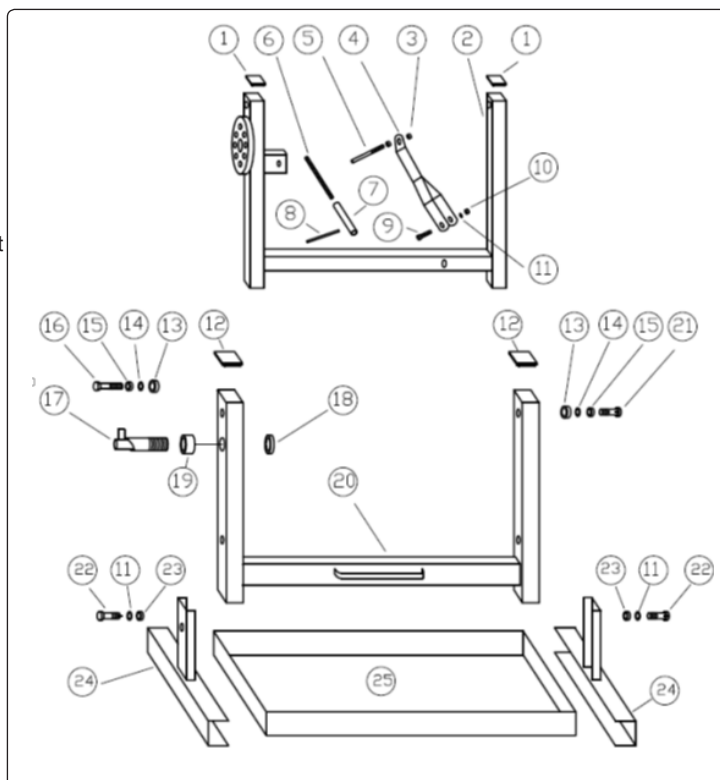

Parts support is available for this product. To obtain a parts listing and/or diagram, please log on to www.sealey.co.uk, email sales@sealey.co.uk or telephone 01284 757500.



Environmental Protection
Recycle unwanted materials instead of disposing of them as waste. All tools, accessories and packaging should be sorted, taken to a recycling centre and disposed of in a manner which is compatible with the environment.
When the product becomes completely unserviceable and requires disposal, drain off any fluids (if applicable) into approved containers and dispose of the product and the fluids according to local regulations.

NOTE: It is our policy to continually improve products and as such we reserve the right to alter data, specifications and component parts without prior notice.

IMPORTANT: No liability is accepted for incorrect use of this product.

WARRANTY: Guarantee is 12 months from purchase date, proof of which will be required for any claim.