

**K21 *Instruction*
Manual**



11" VEHICLE SKATE

Technical Data:

- Capacity: 567kg
- Max. Tyre Width: 267mm
- Working Range: 340 - 710mm
- Net Weight: 15.5kg

Features & Benefits:

- Ideal for a wide variety of workspaces including bodyshops, showrooms, workshops and roadside recovery.
- Reliable ratcheting mechanism is capable of effortlessly lifting a vehicle weighing up to 2.25 Tons.
- Heavy duty nylon castors provide low vibration and low noise.
- Premium bearings allow for hassle free movement of the vehicle in any direction.

Safety Information:

Fully read this instruction manual making note of warnings & cautions, operational requirements & intended use before operating this product.



- Inspect the vehicle skates before each use. **DO NOT** use the vehicle skates if there are any signs of damage, alteration or if there are any components missing.
- This product is intended to move vehicles only, **DO NOT** use this product for any other purpose.
- Only use the skates in pairs.
- **DO NOT** exceed the rated weight capacity.
- Use only on hard level surfaces free from obstruction.
- **DO NOT** exceed the rated tyre diameter.

- Before attempting to move vehicles ensure the wheels are centred and secured.
- **DO NOT** start the vehicle or attempt to drive it whilst the skates are in use.
- **DO NOT** attempt to work on or around vehicles supported by skates.
- Only use a manufacturer approved repair centre.
- When not in use store the vehicle skates in a safe dry location.



Operating Instructions:

1. Make sure the vehicle is on a hard, flat surface with the handbrake engaged.
2. Open the foot pedal hook (9) to release the foot pedal (12).
3. Spread the vehicle skate legs apart wide enough to straddle the vehicle's tyre.
4. Align the skate to centrally straddle the vehicle's tyre.
5. Pull the directional lever (15) backwards towards the foot pedal to engage the ratcheting mechanism.
6. Activate the foot pedal (12) until the rollers contact the circumference of the tyre. At this point ensure the tyre is aligned centrally making any adjustments necessary, it is imperative there should be no contact between the tyre and the red metal frame.
7. Repeat steps 1-6 for the other tyres.
8. Once the vehicle is supported by the skates, transport the vehicle slowly and carefully to its destination.
9. Pull the directional lever (15) forward away from the foot pedal (12) and activate the foot pedal (12) until the rollers clear the circumference of the tyre. Remove the skate.
10. Repeat process 9 for the other tyres.



Setup

Assemble the castors (5) to the inner frame (26) and outer frame (6) with locking nuts (4). Ensure the wheel is locked in place.

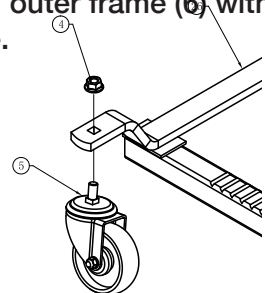



Exploded Diagram & Spares:

PART NO.	DESCIRPTION	QTY	PART NO.	DESCIRPTION	QTY
1	Roller	2	14	Spring	1
2	Castors	4	15	Directional Lever	1
3	Filler Block	4	16	Upper Flat Spring	1
4	Locking Nut	4	17	Bolt	1
5	Castor	4	18	Locking Pawl	1
6	Outer Frame	1	19	Locking Pawl Spring	1
7	Nut	1	20	End Clip Spring	1
8	O-Ring	1	21	End Stop	1
9	Foot Pedal Hook	1	22	Pin	1
10	Pin	1	23	Cotter Pin	1
11	Rubber Plunger	1	24	Washer	1
12	Foot Pedal	1	25	Spring	1
13	Working Pawl	1	26	Inner Frame	1

- Please Note: Spare part numbers are W06-3001- followed by the index number.

