

Warning

Incorrect or out of phase engine timing can result in damage to the valves. The Tool Connection cannot be held responsible for any damage caused by using these tools in anyway.

Our products are designed to be used correctly and with care for the purpose for which they are intended. No liability is accepted by the Tool Connection for incorrect use of any of our products, and the Tool Connection cannot be held responsible for any damage to personnel, property or equipment when using the tools. Incorrect use will also invalidate the warranty.

If applicable, the applications database and any instructional information provided has been designed to offer general guidance for a particular tool's use and while all attention is given to the accuracy of the data no project should be attempted without referring first to the manufacturer's technical documentation (workshop or instruction manual) or the use of a recognised authority such as Autodata.

It is our policy to continually improve our products and thus we reserve the right to alter specifications and components without prior notice. It is the responsibility of the user to ensure the suitability of the tools and information prior to their use.

x

LASER[®]

Part No. 6291

VCT Setting Kit

Ford 1.0 GTDi VCT



 **MADE IN
SHEFFIELD**

Introduction

Engine Timing Tool Kit Ford 1.0 litre 3 Cylinder EcoBoost with VCT.

Specifically designed for the new Ford 1.0lt 3 cylinder EcoBoost engines and used in conjunction with 6290 to assemble the VCT (Variable Camshaft Timing) units on the camshafts in their TDC position without play.
Required to align the VCT units when they are assembled on the camshafts.

The information given below is for reference only.

The Tool Connection Ltd recommends the use of Manufacturer data or Autodata.

The Tool Connection cannot be held responsible for damage to engine or personnel whilst using this tool kit.

Make	Model	Type	Year	Engine Code
Ford	B-MAX C-MAX EcoSport Fiesta Focus Grand C-MAX Grand Tourneo Connect Tourneo Connect Transit Connect Transit Courier	EcoBoost EcoNetic SCTi EcoBoost	2012 to 2015	M1JA SFJA SFJB M1DA M2DA P4JA P4JB XMJA XMJB M1JE M2GA

Plan Layout

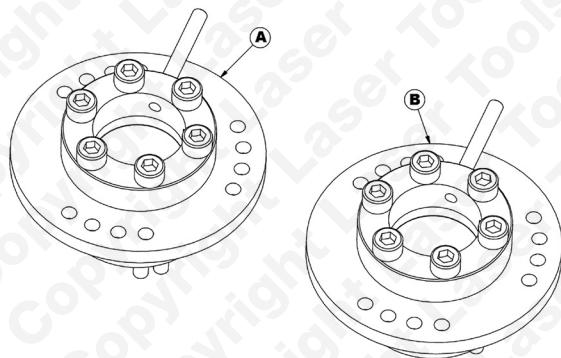

Ref	Code	OEM Number	Description
A	C706	303-1606/1	VCT Locking Tool - Inlet
B	C707	303-1606/2	VCT Locking Tool - Exhaust

Instructions

Preparation

- Always refer to manufacturer specific data and instructions
- Turn engine to TDC No.1 cylinder before disassembly of engine
- Used with the front engine cover fitted.

Component Descriptions:

Components A:

Used to set up the Variable Camshaft Timing pulleys (VCT).

The special tool set 6291 is used in conjunction with 6290 engine timing kit to assemble the VCT (Variable Camshaft Timing) pulleys in to their camshafts at TDC.

After assembly of the camshaft drive belt, belt tensioner, front cover, oil seal and crankshaft front pulley with the crankshaft and camshaft still locked at TDC fit components A & B as shown and tighten bolts (1) to 10Nm. Turn the inlet tool and the exhaust tool anti-clockwise to remove any play. Tighten the VCT fixings (2) to the correct torque as described by OEM instructions.

See Fig.1 and 2.

N.B: refer to OEM data and information for full instruction.

N.B. On engines equipped with VCT, if the VCT pulleys require removal or loosening ensure their initial position is marked with chalk or paint.

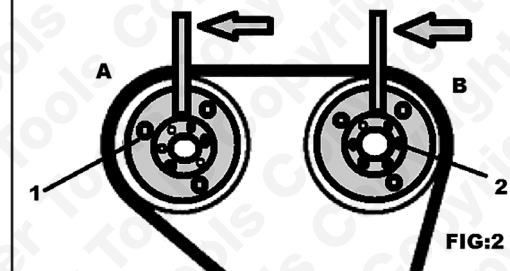
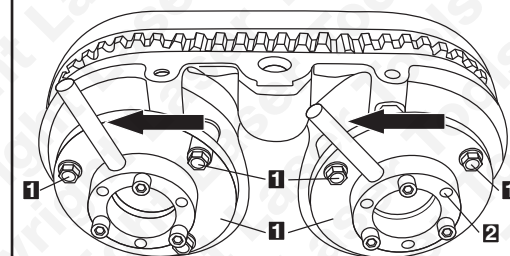

Butts of Bawtry

Station Yard Bawtry Doncaster South Yorks DN10 6QD UK

Tel: 0044 (0)1302 710868 Fax: 0044 (0)1302 719481

Web: www.buttsofbawtry.com Email: info@buttsbawtry.com

